

EvominiSER-LUX

Illuminance transmitter with Modbus RTU digital output (RS485)

By using a single cable, it is possible to build a sensors network which can be directly connected to a PLC or a PC equipped with a supervisory software (SCADA). These devices are equipped with M12 connectors allowing for an easy and quick installation with degree of protection IP67. The sensor can detect the ambient light in the range 0÷167 Klx. No calibration is needed. The M12 connector allow a simply installation and replacement.

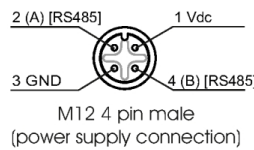
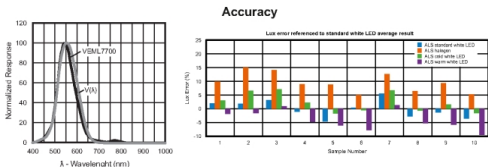
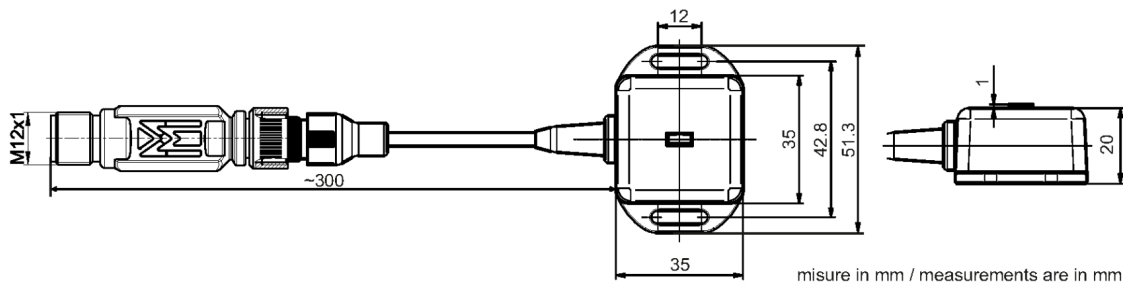

«T» Distributor

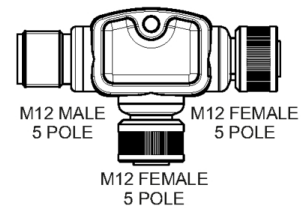

TECHNICAL SPECIFICATION

| | |
|-----------------------------|---|
| Power supply | 9 ±32 Vdc (polarity protected) |
| Current consumption | <4mA with RS485 (<10mA at power on for approx. 8mS) |
| Communication protocol | Modbus RTU (max. baud rate 38.400) |
| Serial interface | RS-485 (not insulated) |
| Maximum connection distance | 1000 meters, this distance depends on the power supply voltage and the type of cable used to connect the various devices |
| Maximum devices on network | Maximum 256 nodes (it is recommended to use isolators / repeaters along the serial line) |
| Input/Output insulation | None |
| Indicator LED | Blue LED, power supply and device operations indicator Red LED (ERR), sensor error indicator White LEDs (TX and RX), serial transmission and reception indicators |
| PCB operating temperature | -40 ±80°C |
| EMC | According to EN 61326-1:2013 |
| Configuration | By using the EVOPLATFORMSET configuration kit (a PC with Windows OS is required). |
| Sensor working range | Temperature: -25 ±85 °C |
| Accuracy | refer to the specific graphs |
| Measurement range | 0 ±167 lx |
| Resolution | 0.005 lx |
| Box material | ABS black |
| Type of connector | male 4-pin connector with M12x1 metal screw lock (in accordance with IEC 61076-2-101 STANDARDS) |

ORDER CODE

| | |
|---------------|----------------|
| EVO032 | Transmitter |
| EVO035 | Digital sensor |