

F028005A

Rev. 0 - 24/05/2021

Double Pt100 probe with tapered thermowell

Double RTD with densely packed mineral insulation (M.I.C.) with connection head and thermowell

- 2 Pt100 cl.B sensin element
- replaceable insert
- Ø 6 mm reduced to Ø 4 mm tube thermowell-
- 1/2 G process connection

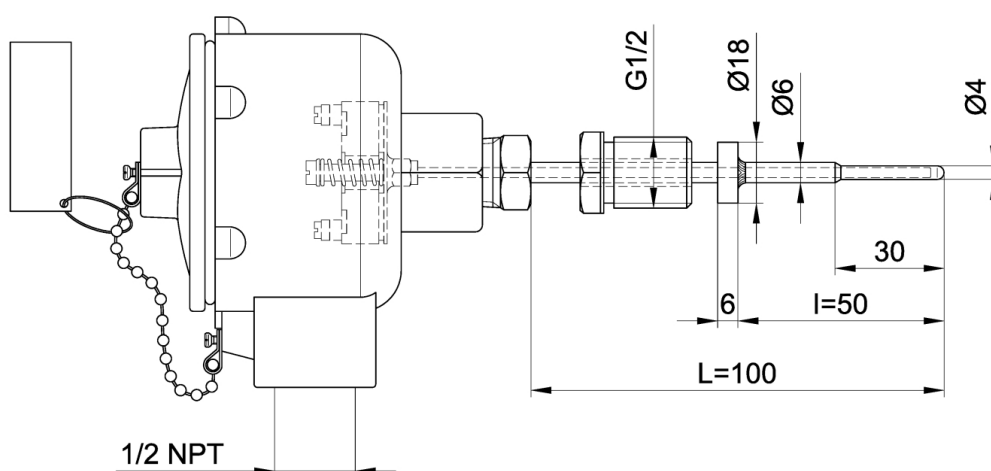

TECHNICAL SPECIFICATION

Sensing element	Pt100 Ω @ 0°C
Sensing Element configuration	double 6-wire
Accuracy class in accordance to IEC751 (*) (*) Pt 100 cl.A only available with 3 or 4 wires, cl.AA 4 wires only; Pt 1000 cl. A available with 2 wires only for cable lengths below 1 m, for longer cables only available with 3 or 4 wires, cl. AA 3 wires for cable lengths below 1 m, for longer cables only 4 wires.	cl. B, Operating range (in which the accuracy class is guaranteed) -50 ÷ 500°C
Insulation resistance	100 M Ω @ 100 Vdc.
Process connection (*) (*) Thread STANDARDS (CYL. GAS in accordance with UNI-ISO 228) (CON. GAS in accordance with UNI-ISO 7-1) (NPT in accordance with ANSI B 1.20.1)	male thread G 1/2"UNI ISO 228
Immersion l	50 mm
Fixing system	threaded connection
Thermowell rod	Ø 6 mm with reduced tip Ø 4 x 30 mm
Sheet material	AISI 316
Connection head / junction box	Atex EEXD IIC T6 All. 1/2"-1/2" head
Connection head / junction box material	COATED ALUMINIUM
inside connection head	ceramic terminal block
International protection marking (*) (*) According to IEC 60529	IP66